

MAP
OF THE LANDS OF
RANCHO - SIMI
VENTURA & LOS ANGELES COUNTIES
CALIFORNIA
BELONGING TO
Simi Land & Water Company.
SHOWING THE SUBDIVISIONS

SCALE 80 CHAINS TO ONE INCH
Magnetic Variation 14° 25' E.

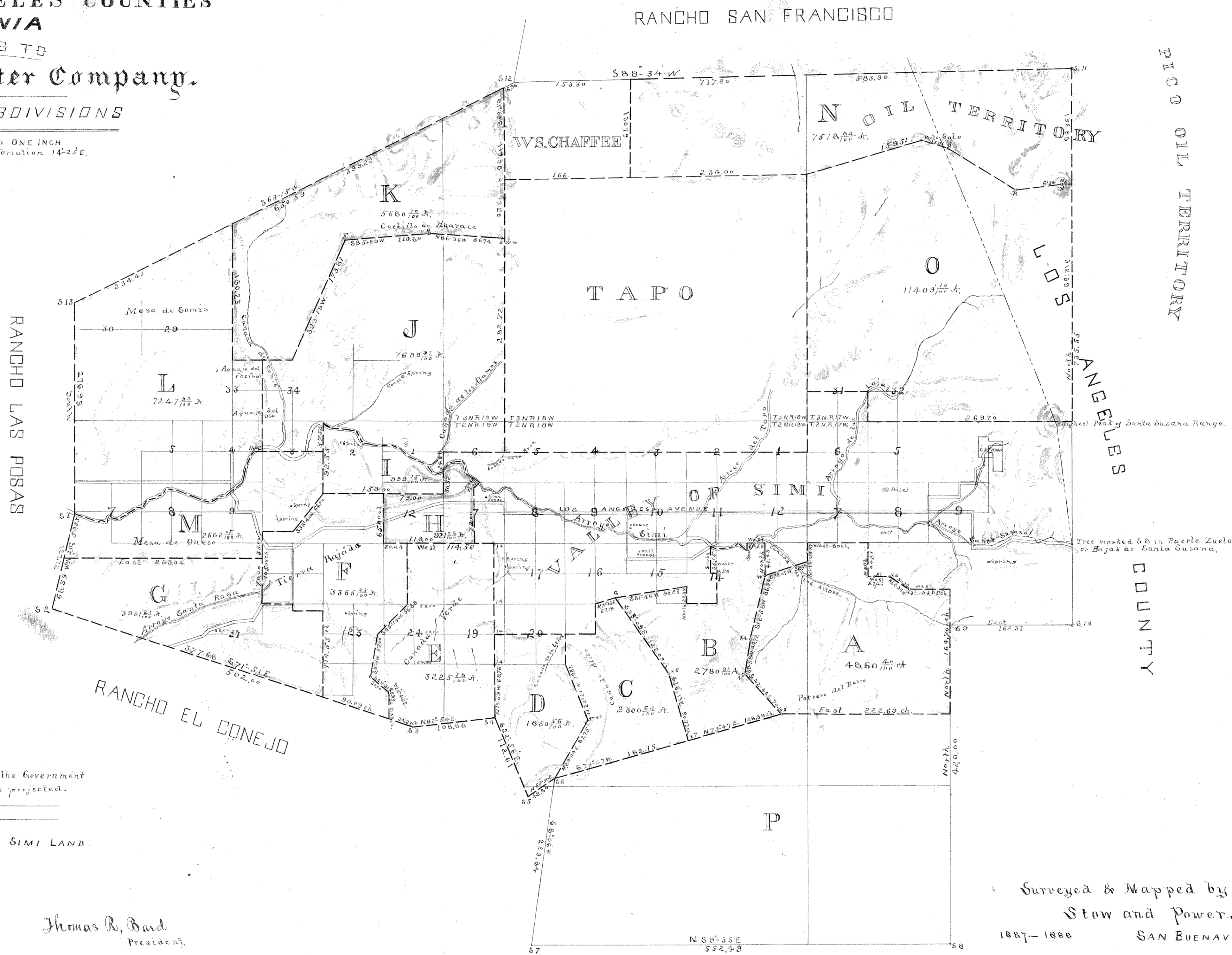

NOTE For convenience in subdividing and plotting the nomenclature of the Government Surveys has been adopted, and the Township Range and Section lines projected. In this Survey is altogether independent of the Government Surveys. All Roads and Avenues on this Map are 60 feet wide.

This Map adopted by Resolution of the Board of Directors of the SIMI LAND & WATER Co. passed March 11th 1886

R.W. Pindexter
Secretary

Thomas R. Bard
President

Surveyed & Mapped by
Stow and Power
1887-1888
SAN BUENAVENTURA, CALA.

Recorded at the request of *Thomas R. Bard*
July 7th 1888 at 10 A.M.

L. J. Eastin Recorder